

Set-up Expand LinkWall

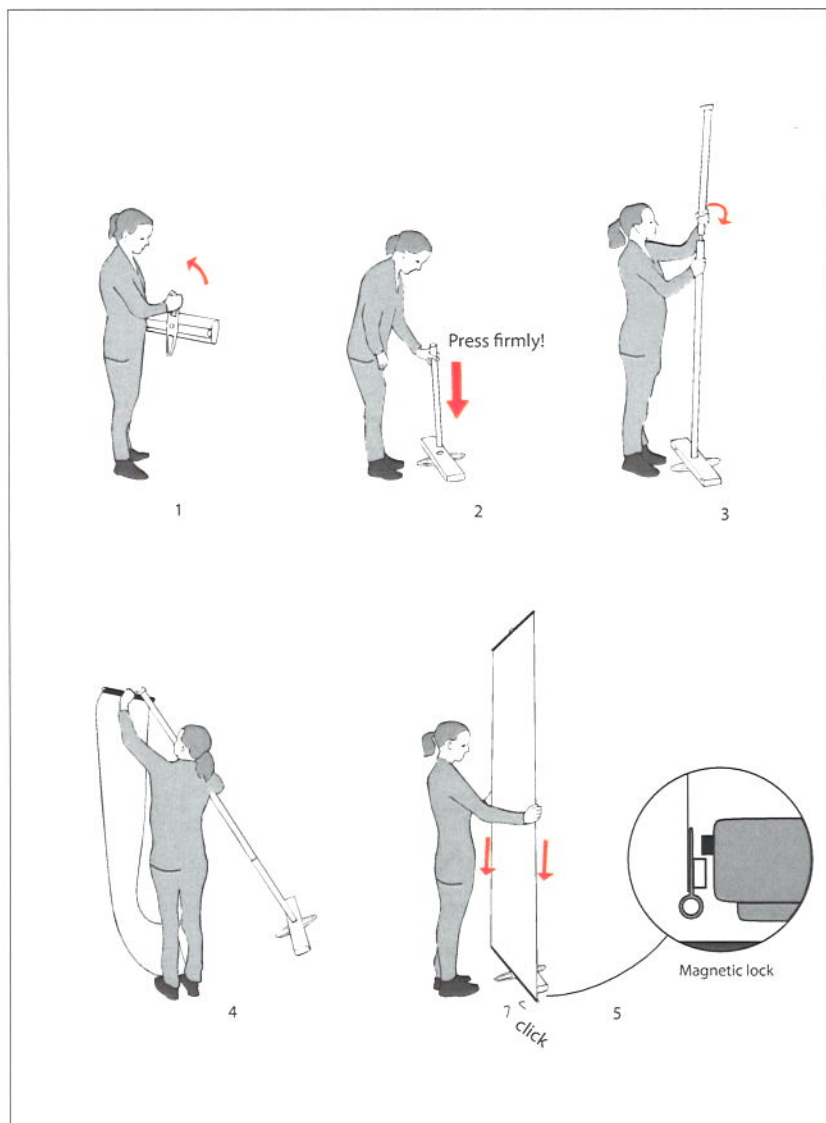

Set-up with flex link panel (for taller versions a ladder is recommended)

220 cm height

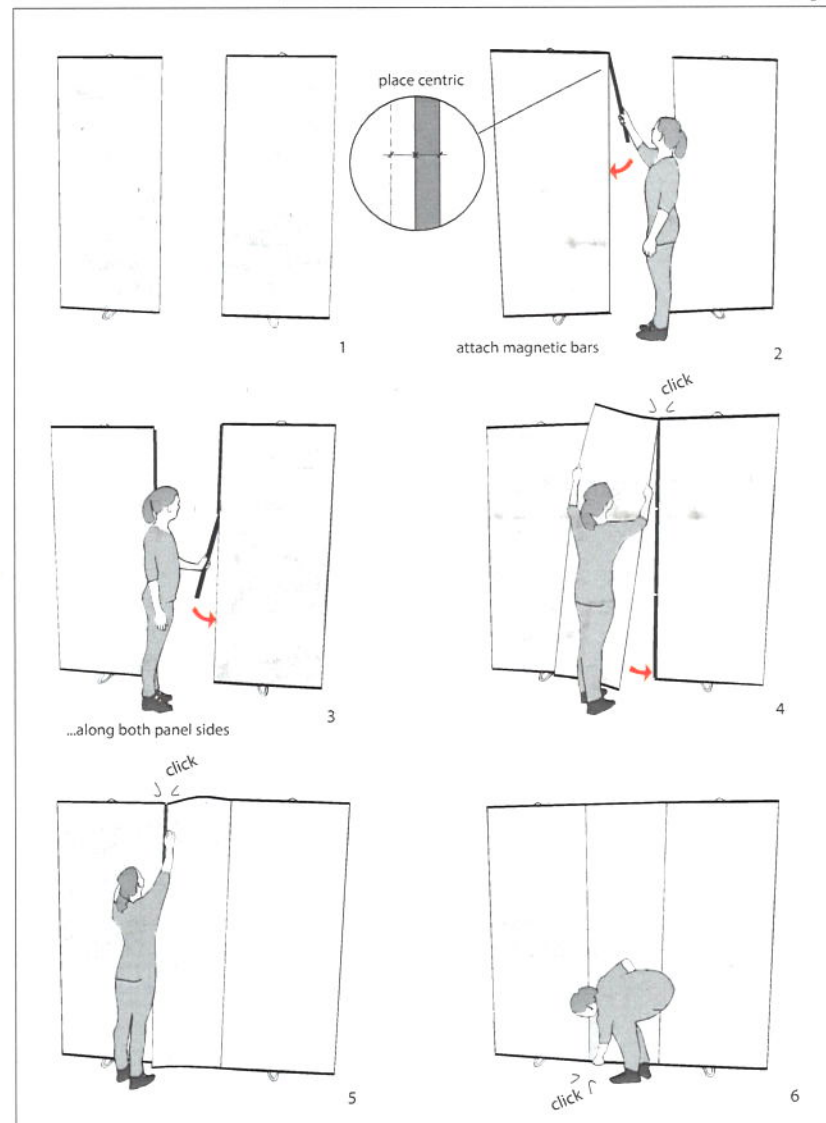

Set-up without flex link panel (for taller versions a ladder is recommended)

220 cm height

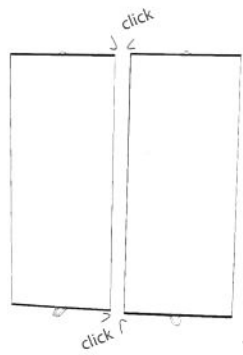

1



attach magnetic bars

2

How to attach end panel

for double sided unit

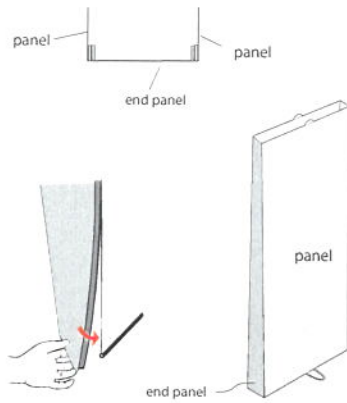

for single sided unit

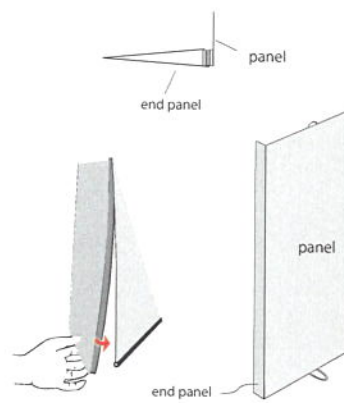

How to align graphics

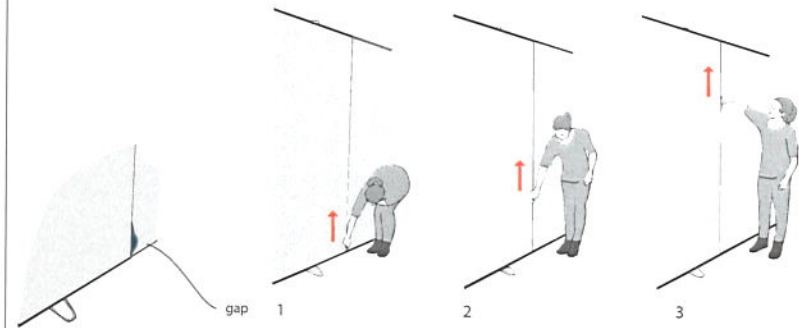

Attaching spotlights

Expand Spotlight 50W

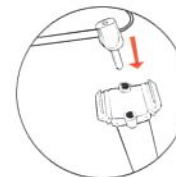

Expand Spotlight 150W/LED

